

GUIDE PILLAR WITH INTERNAL THREAD ON BOTH SIDES, ~DIN 9825/~ISO 9182-2

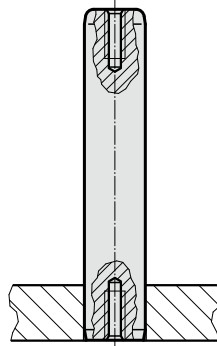

Mounting example



202.22.

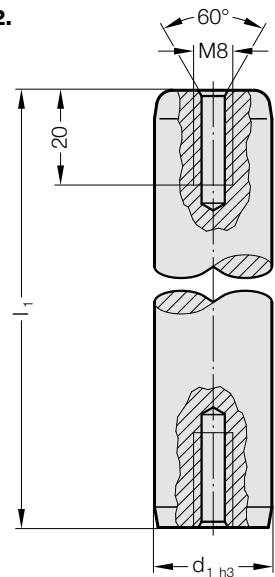

Material:

Steel, (Core strength: $\geq 900 \text{ N/mm}^2$) surface hardened
 Surface hardness: 60 + 3 HRC, Hardness penetration $\geq 1,8 \text{ mm}$

Execution:

fine-ground and superfinished
 Method of manufacturing entails that centre holes are not concentric with O.D.

Note:

☞ Bearing clearance / Preloading see pairing classification at the beginning of chapter D.

☞ Matching guide combinations, see selection matrix at the beginning of chapter D.

☞ Assembly guide lines / Dimensional requirements and tolerances at the end of chapter D.

Tolerance range:

yellow = .10

green = .20

red = .30

202.22. Guide pillar with internal thread on both sides, ~DIN 9825/~ISO 9182-2

d_1	15 16	19 20	24 25	30 32	38 40	48 50	60 63	80
l_2	4	4	6	6	6	8	8	8
l_1								
90	●							
100	●	●	●					
112	●	●	●					
125	●	●	●	●				
140	●	●	●	●				
160	●	●	●	●	●			
180	●	●	●	●	●	●		
200	●	●	●	●	●	●	●	
224	●	●	●	●	●	●	●	
250	●	●	●	●	●	●	●	
280	●	●	●	●	●	●	●	●
315	●	●	●	●	●	●	●	●
355	●	●	●	●	●	●	●	●
400		●	●	●	●	●	●	●
450			●	●	●	●	●	●
500			●	●	●	●	●	●
550				●	●	●	●	●
600				●	●	●	●	●
700				●	●	●	●	●
800				●	●	●	●	●

Ordering Code (example):

Guide pillar with internal thread on both sides, ~DIN 9825/~ISO 9182-2	= 202.22.
Diameter of conduit d_1	32 mm = 032.
Length l_1	200 mm = 200.
Classification TOL	yellow = 10
Order No	= 202.22. 032. 200. 10