

# GUIDE BUSH WITH COLLAR, BRONZE WITH SOLID LUBRICANT

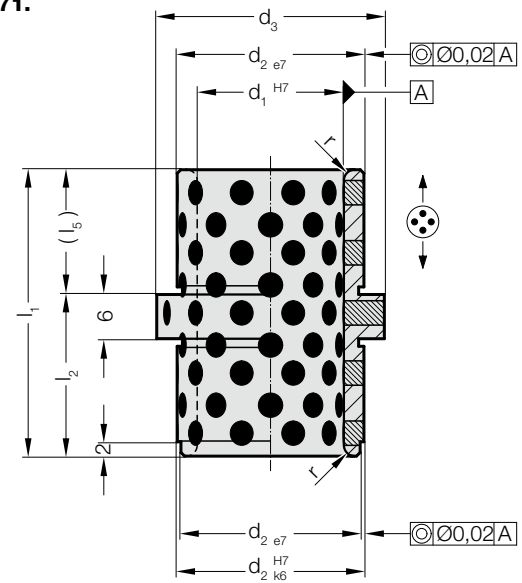

2087.71.



**Material:**

Bronze with solid lubricant, oilless lubricating

**Note:**

☞ Assembly guide lines / Dimensional requirements and tolerances at the end of chapter D.

**Attention:**

Bushes can only be used with axial motion!

**2087.71. Guide bush with collar, Bronze with solid lubricant**

|       |       |       |       |       |
|-------|-------|-------|-------|-------|
| $d_1$ | 14 15 | 18 20 | 22 24 | 30 32 |
| $d_2$ | 20    | 26    | 30    | 42    |
| $d_3$ | 25    | 31    | 35    | 47    |
| $r$   | 1     | 1.5   | 2     | 2     |
| $l_1$ | 26    | 39    | 49    | 63    |
| $l_2$ | 17    | 22    | 27    | 36    |
| $l_5$ | 9     | 17    | 22    | 27    |

**Ordering Code (example):**

|   |                    |
|---|--------------------|
| Guide bush with collar, Bronze with solid lubricant | =2087.71.          |
| Diameter of conduit $d_1$                           | 22 mm = 022.       |
| Length with bush $l_2$                              | 27 mm = 027        |
| Order No  | =2087.71. 022. 027 |