

# GUIDE BUSH WITH COLLAR, BRONZE WITH SOLID LUBRICANT

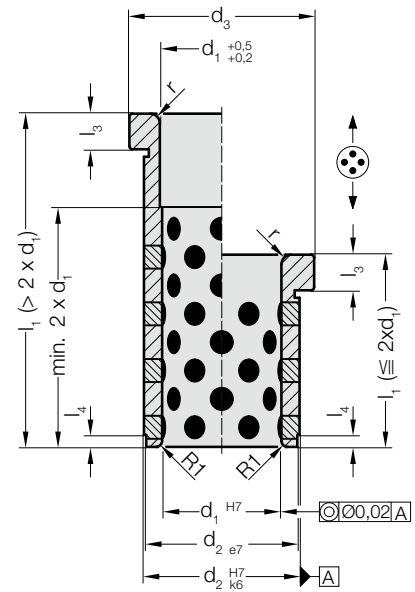

2087.72.



**Material:**

Bronze with solid lubricant, oilless lubricating

**Note:**

☞ Assembly guide lines / Dimensional requirements and tolerances at the end of chapter D.

**Attention:**

Bushes can only be used with axial motion!

**2087.72. Guide bush with collar, Bronze with solid lubricant**

d <sub>1</sub>	9 10	12	14 15	16	18 20	22 24	25	30 32	40 42	50	60
d <sub>2</sub>	14	18	20	22	26	30	32	42	54	66	80
d <sub>3</sub>	16	23	25	27	31	35	38	47	60	72	86
r	0.5	1	1	2	2	3	3	3	3	3	3
l <sub>3</sub>	3	6	6	6	6	6	6	6	10	10	20
l <sub>4</sub>	1.5	2	2	2	2	3	3	4	5	5	5
l <sub>1</sub>											
12	●										
17	●	●	●	●	●	●					
22	●	●	●	●	●	●					
27	●	●	●	●	●	●					
36	●	●	●	●	●	●					
46	●	●	●	●	●	●	●	●	●		
56	●	●	●	●	●	●	●	●	●	●	
66											
76											
86											
96											
116											
136											
156											
196											

**Ordering Code (example):**

Guide bush with collar, Bronze with solid lubricant	=2087.72.
Diameter of conduit d <sub>1</sub>	22 mm = 022.
total length l <sub>1</sub>	17 mm = 017
Order No	=2087.72. 022. 017