

CONTROL FITTING

2480.00.30.13.1 without pressure switch, with pressure relief

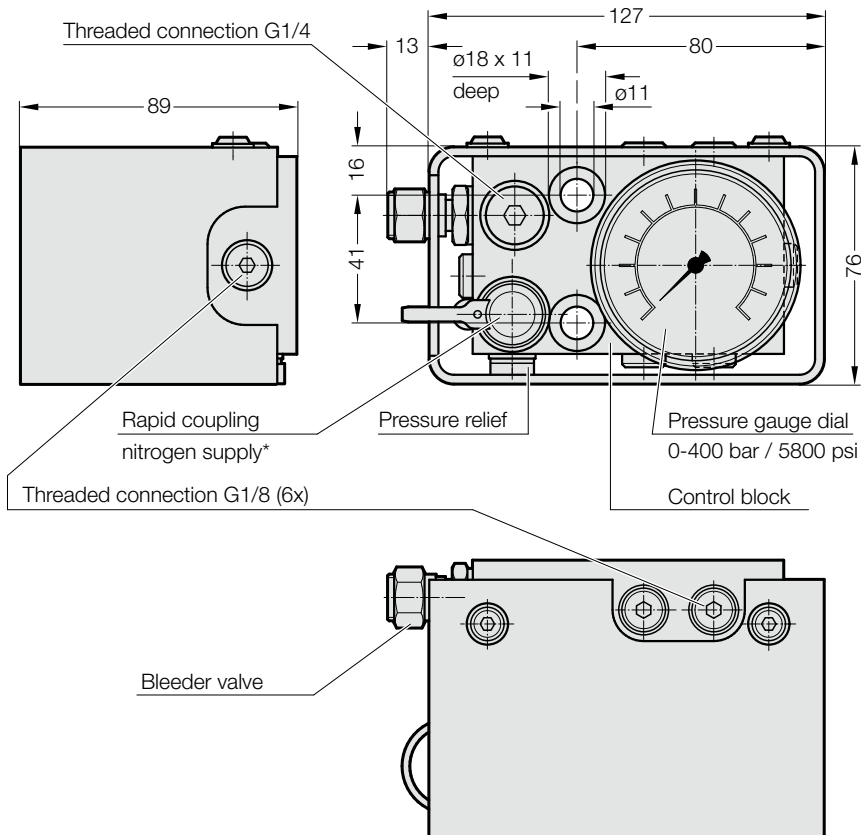

Description:

The control fitting 2480.00.30.13.1 is used to constantly monitor the filling pressure of one or more gas springs. The control fitting is equipped with rapid coupling for nitrogen supply and a bleeder valve. There are three G1/8 ports for simultaneous pressure checking at the control fitting. Measuring range from 0 - 400 bar / 5800 psi.

Note:

* 2 m long filling hose
Order no. 2480.00.31.02
order separately

2480.00.30.14.1 (600 bar) without pressure switch, without pressure relief

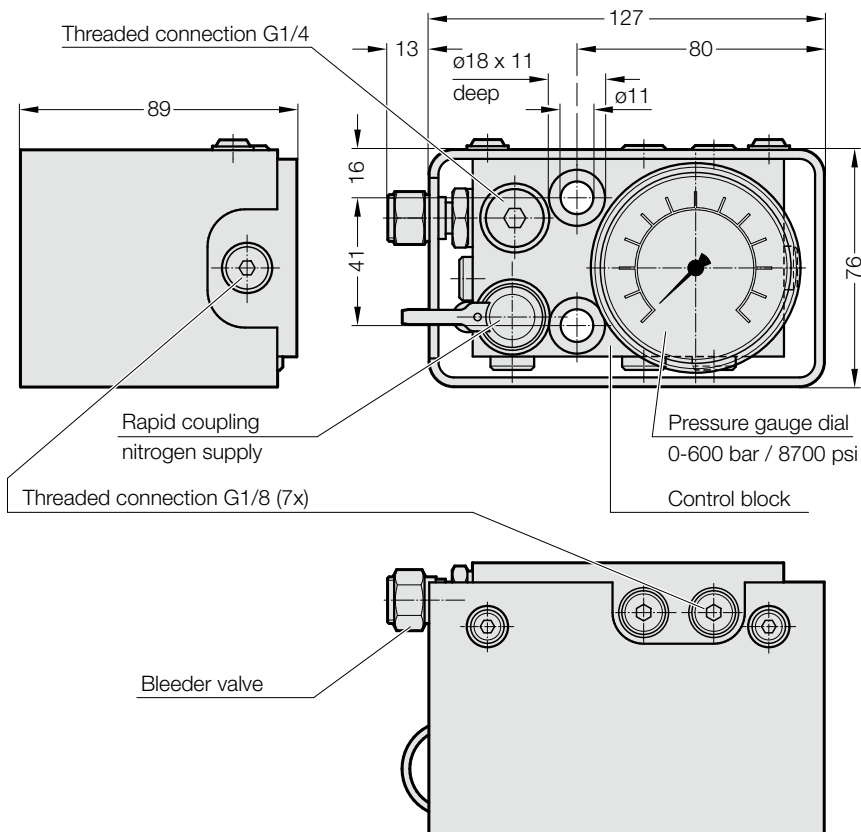

Description:

The control fitting 2480.00.30.14.1 is used for the constant monitoring of filling pressures > 150 bar of one or more gas springs. The control fitting is equipped with rapid coupling for nitrogen supply and a bleeder valve. There are three G1/8 ports for simultaneous pressure checking at the control fitting. Measuring range from 0-600 bar (8700 psi).

Note:

* 2 m long filling hose
Order no. 2480.00.31.02
order separately