

# PUNCH, BLANK, WITH EJECTOR PIN, ISO 8020

2701.

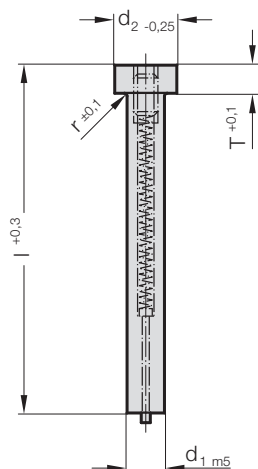

## 2701. Punch, blank, with ejector pin, ISO 8020

d <sub>1</sub> / Order No	d <sub>2</sub>	r	T	l / (Order Code character)	71 (D)	80 (E)	90 (F)	100 (G)	120 (J)
5 / (3)	8	0.3	5		●	●	●	●	●
6 / (4)	9	0.3	5		●	●	●	●	●
8 / (5)	11	0.3	5		●	●	●	●	●
10 / (6)	13	0.3	5		●	●	●	●	●
13 / (7)	16	0.4	5		●	●	●	●	●
16 / (8)	19	0.4	5		●	●	●	●	●
20 / (9)	23	0.4	5		●	●	●	●	●
25 / (10)	28	0.4	5		●	●	●	●	●
32 / (11)	35	0.4	5		●	●	●	●	●

### Ordering Code (example):

**2701.8G**

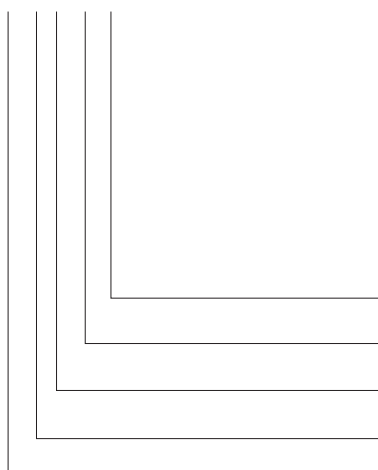

**Length: l**  
100 mm  
**Diameter: d<sub>1</sub>**  
16 mm  
**Type:**  
ISO  
**Execution:**  
blank  
**Punch:**  
with ejector pin

**Order Code character**  
= (G)  
**Order No**  
= (8)  
**Order No**  
= (1)  
**Order No**  
= (0)  
= 27

### Material:

HSS  
Hardness:  
Shaft 64 ± 2 HRC  
Head 52 ± 5 HRC

### Execution:

Punch head hot upset-forged. Shoulder and shaft fine ground.  
Special dimensions on request.