

PUNCH WITH TAPERED HEAD, STEPPED, ROUND, WITH EJECTOR PIN, ~DIN 5118 SHAPE F

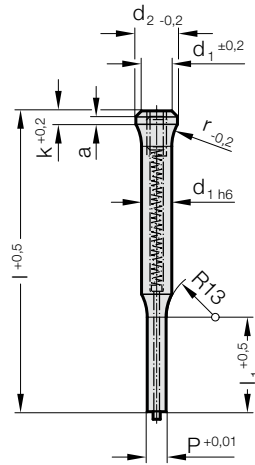

2716.



2716. Punch with tapered head, stepped, round, with ejector pin, ~DIN 5118 Shape F

d ₁ / Order No	d ₂	P	l ₁ / Order No	a	k	r	l (Order Code character)	71 (D)	80 (E)	90 (F)	100 (G)	120 (J)
5 / (3)	7	2 - 4.9	13 (3) 19 (4)	1.5	4	10		●	●	●	●	●
6 / (4)	9	2.5 - 5.9	13 (3) 19 (4)	1.5	4	10		●	●	●	●	●
8 / (5)	11	4 - 7.9	19 (4) 25 (5)	1.5	4	12		●	●	●	●	●
10 / (6)	14	5 - 9.9	19 (4) 25 (5)	1.5	4	15		●	●	●	●	●
13 / (7)	17	6 - 12.9	19 (4) 25 (5)	1.5	4	15		●	●	●	●	●
16 / (8)	20	8 - 15.9	19 (4) 25 (5)	1.5	4	15		●	●	●	●	●
20 / (9)	25	10 - 19.9	19 (4) 25 (5)	1.5	4	15		●	●	●	●	●

Material:

HSS

Hardness:

Shaft 62-66 HRC

Head 45-55 HRC

Description of FIBRO materials for tool and die components see at the beginning of Chapter E.

Execution:

Shaft precision ground. Head subsequently hot upset-forged and tempered.

Note:

Matching piloted counterbore 2284.00.

Matching retainer ring 2284.00.01.

Ordering Code (example):

2716.7G4.0720

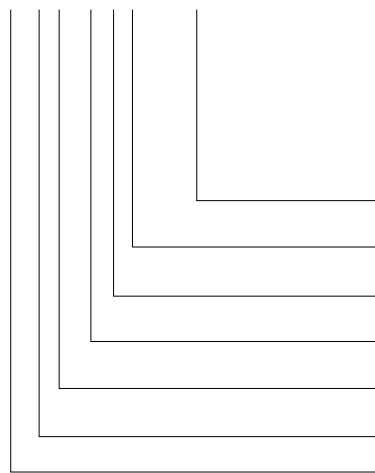

Shape: round

P = ø7,2 mm

Punch cutting length: l₁
19 mm

Length: l
100 mm

Diameter: d₁
13 mm

Type:
with tapered head

Execution:
round

Punch:
with ejector pin

= 0720

Order No
= (4)

Order Code character
= (G)

Order No
= (7)

Order No
= (6)

Order No
= (1)

= 27