

# DRILL BUSH WITH COLLAR, DIN 172 SHAPE A

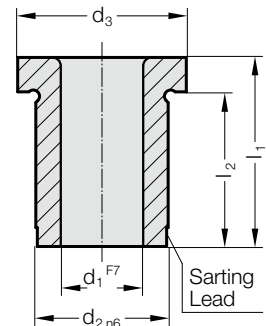

276.



### Material:

Case hardened steel  
Hardness 740 ± 40 HV 10

### Execution:

Diameters  $d_1$ ,  $d_2$  and shoulder precision ground.

Other diameters and lengths on request.

### 276. Drill bush with collar, DIN 172 Shape A

$d_1$	$d_2$	$d_3$	Gradation	$l_1$	6	8	9	10	12	16	20	25	28	30	36	45	56	67
0,9 - 1	3	6	0.1	$l_2$	4		7											
1,1 - 1,8	4	7	0.1		4		7											
1,9 - 2,6	5	8	0.1		4		7											
2,7 - 3,3	6	9	0.1			5.5			9.5	13.5								
3,4 - 4	7	10	0.1			5.5			9.5	13.5								
4,1 - 5	8	11	0.1			5.5			9.5	13.5								
5,1 - 6	10	13	0.1				7			13	17							
6,1 - 8	12	15	0.1				7			13	17							
8,1 - 10	15	18	0.1					9			17	22						
10,1 - 12	18	22	0.1					8			16	21						
12,1 - 15	22	26	0.1							12			24		32			
15,5 - 18	26	30	0.5							12			24		32			
18,5 - 22	30	34	0.5								15				31	40		
22,5 - 26	35	39	0.5								15				31	40		
26,5 - 30	42	46	0.5									20				40	51	
30,5 - 35	48	52	0.5									20				40	51	
35,5 - 42	55	59	0.5											25			51	62

### Ordering Code (example):

Drill bush with collar, DIN 172 Shape A = 276.1.

Diameter of conduit  $d_1$  12.1 mm = 1210.

Length  $l_1$  16 mm = 016

Order No = 276.1. 1210.016